

NO MECHANICAL HOUSING TO HOLD THE TFT AND THE TOUCH PANEL ON THIS PRODUCT, SO THE END UNIT'S MECHANICAL DESIGN MUST INCLUDE A HOUSING FOR PREVENTING THE SEPARATION OF THE TFT AND THE TOUCH PANEL.

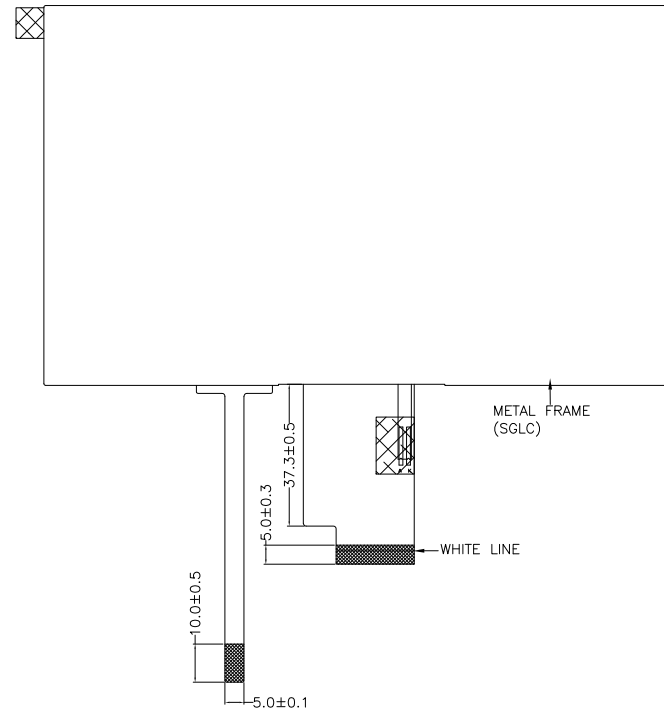
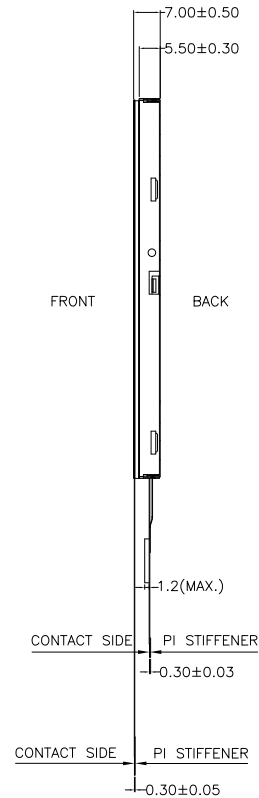
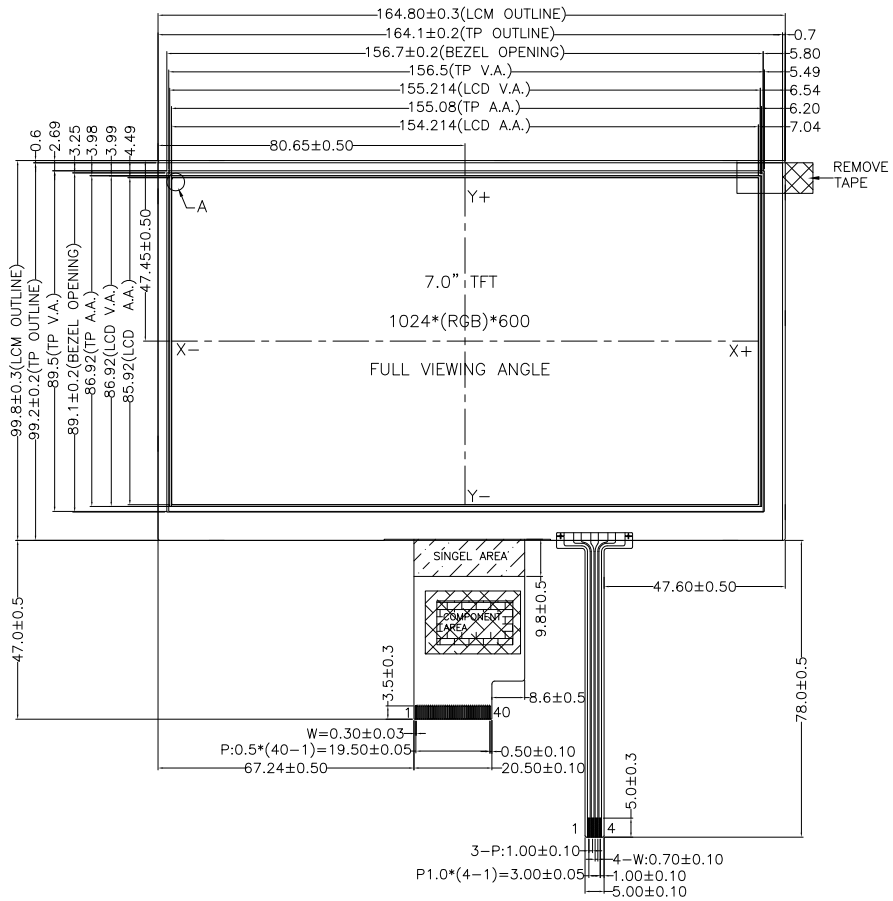

| PIN ASSIGNMENT FOR LCM | |
|------------------------|--------|
| PIN | SYMBOL |
| 1 | VCOM |
| 2 | DVDD |
| 3 | DVDD |
| 4 | NC |
| 5 | RESET |
| 6 | STBYB |
| 7 | GND |
| 8 | NIND0 |
| 9 | PIND0 |
| 10 | GND |
| 11 | NIND1 |
| 12 | PIND1 |
| 13 | GND |
| 14 | NIND2 |
| 15 | PIND2 |
| 16 | GND |
| 17 | NINC |
| 18 | PINC |
| 19 | GND |
| 20 | NIND3 |
| 21 | PIND3 |
| 22 | GND |
| 23 | NC |
| 24 | NC |
| 25 | GND |
| 26 | NC |
| 27 | NC |
| 28 | SELB |
| 29 | AVDD |
| 30 | GND |
| 31 | LED_K |
| 32 | LED_K |
| 33 | SHLR |
| 34 | UPDN |
| 35 | VGL |
| 36 | NC |
| 37 | NC |
| 38 | VGH |
| 39 | LED_A |
| 40 | LED_A |

| PIN ASSIGNMENT FOR RTP | |
|------------------------|--------|
| PIN | SYMBOL |
| 1 | Y+ |
| 2 | X- |
| 3 | Y- |
| 4 | X+ |

NOTES:

1. DISPLAY TYPE: TFT, TRANSMISSIVE, NORMALLY BLACK
2. OPERATING VOLTAGE: DVDD=3.3V (TYP.)
3. VIEWING DIRECTION: FULL VIEWING ANGLE
4. DRIVER IC: HX8282A01+HX8696A
5. OPERATING TEMP.: -20°C ~ 70°C
6. STORAGE TEMP.: -30°C ~ 80°C
7. LED BACKLIGHT: WHITE LED, IF=180mA, VF=16.8V~20.4V
8. SURFACE LUMINANCE: 480CD/M² (TYP.)
9. TOP POLARIZER SURFACE TREATMENT: ANTI-GLARE
10. ONLY THE SINGLE LAYER AREA ON FPC IS BENDABLE AND THE MINIMUM BEND RADIUS IS 1.5MM
11. GENERAL TOLERANCE: ±0.3MM
12. ROHS COMPLIANT

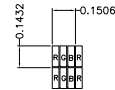

DETAIL A
(SCALE 40:1)



BACKLIGHT CIRCUIT DIAGRAM



MULTI-INNO TECHNOLOGY CO., LTD.

| | | | | |
|--------------|------|------------|----------------|------------------|
| DRAWN BY: | RITA | 2023.05.23 | | MODULE P/N: |
| CHECKED BY: | | | SCALE : 1/1 | MI0700CHT-2RP |
| APPROVED BY: | | | UNIT: mm | DESCRIPTION: |
| VERSION NO: | 01 | | SHEET NO.: 1/1 | TFT + RTP MODULE |

| | | | |
|------|---------------------|---------|------------|
| 01 | FIRST ISSUE | RITA | 2023.05.23 |
| VER. | REVISED DESCRIPTION | REVISER | DATE |